

## Entertainment and Hospitality

### Project Information



**Product:** SQUARELINE® Metal Ceiling Tiles  
**Application:** Stadium  
**Architect:** Hammel, Green and Abrahamson



**Product:** SQUARELINE Metal Ceiling Tiles  
**Application:** Museum Gallery  
**Architect:** Ennead architects

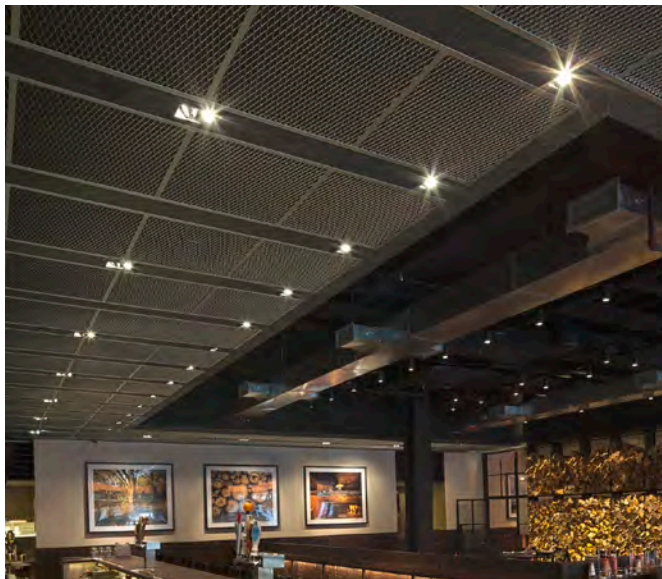

**Product:** BIOLINE® Organic Wood Ceiling Tiles,  
SQUARELINE Metal Ceiling Tiles  
**Application:** Restaurant  
**Architect:** Bentel and Bentel



**Product:** SONEX® Panels  
**Application:** Children's Museum Gallery  
**Architect:** Architecture Incorporated

To learn more about these and other applications, visit our website at [www.pinta-acoustic.com/ent](http://www.pinta-acoustic.com/ent).

## Entertainment and Hospitality

### Project Information



**Product:** SQUARELINE® Metal Ceiling Tiles  
**Application:** Fitness Facility  
**Architect:** Kirksey Architecture



**Product:** WHISPERWAVE™ Baffles  
**Application:** Retail  
**Architect:** Studio 3 Designs

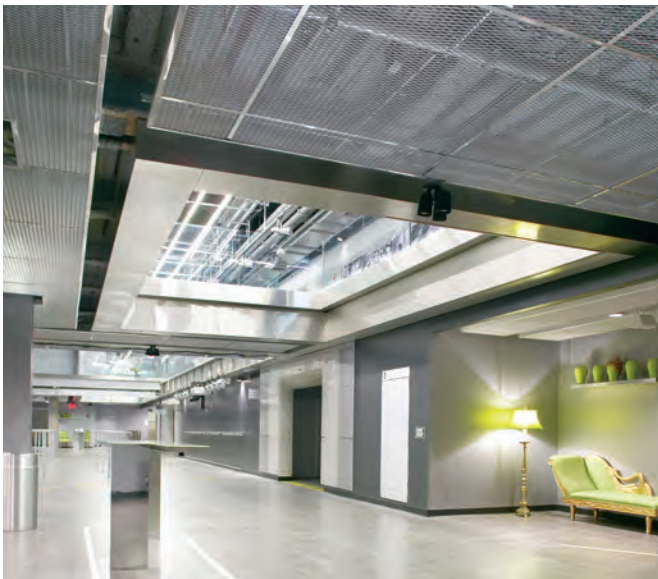

**Product:** SQUARELINE Metal Ceiling Tiles  
**Application:** Theater performing arts  
**Architect:** Beyer Blinder Belle Architects and Planners, LLP



**Product:** SONEX® Rondo Baffles  
**Application:** Indoor Swimming Pool  
**Artist:** Xavier Cortada

To learn more about these and other applications, visit our website at [www.pinta-acoustic.com/ent](http://www.pinta-acoustic.com/ent).

### Entertainment and Hospitality Project Information



Project: LINDSAY - Major Living Area  
Application: Lounge  
Acoustic Solution: Sound reinforcement



Project: SYDNEY - Major Living Area  
Application: Restaurant/Bar  
Acoustic Solution: Sound reinforcement



Project: LINDSAY - Major Living Area  
Application: Lounge  
Acoustic Solution: Sound reinforcement



Project: LINDSAY - Major Living Area  
Application: Restaurant/Bar  
Acoustic Solution: Sound reinforcement

© 2013 Pinsa Acoustics. All rights reserved. For more information, visit us at [www.pinsa.com](http://www.pinsa.com)